

Expanding God's Love through **Connection** and **Outreach**



**Westminster
Presbyterian Church**
Capital Campaign

A Place for Everyone



“This exciting plan will allow Westminster to significantly improve connection and outreach to our church family, mission recipients, and community partners by making our building more accessible.” -Dave and Rachael Boezi

A Letter to the Congregation

Friends, Our greatest glory is ahead of us.

In 1949, in a history celebrating our 150th anniversary as a church, Jerry Fox Vincent wrote this about Westminster:

A church may be said to be the soul of a community . . . This church rejoices in its past, but its past is not its greatest glory. That lies in the future. Tomorrow calls. The future asks us to rise and build a greater church . . . bound up with the ideals of the Kingdom of Heaven on earth.

And in his letter to the church at Corinth, the Apostle Paul agrees, our greatest glory is ahead of us:

All of us, seeing the glory of the Lord, seeing at the glory of the Lord, are being transformed into the same image of glory . . . For whatever slight momentary affliction we have now is preparing us for an eternal weight of glory.

Yes, our greatest glory—an eternal weight of glory beyond all measure—awaits us in the next life. But a glimpse—a foretaste, a sneak preview—of that glory can be ours here and now in this life. That’s why our *Book of Order*, part of the Constitution of the Presbyterian Church USA, identifies one of the great ends of the church as “the exhibition of the Kingdom of Heaven to the world.” When we share God’s human connection and human care with one another and the world, we exhibit the Kingdom of Heaven and we experience the glory of God. I know you know that, that you have experienced something of that glory, and have experienced it here at Westminster.

Now the future is calling us to rise and build a greater church, one that will enable us to do more of what we already do in exhibiting God’s Kingdom, and do it better. Because, as beautiful and as historic as our church building is, we need to make it more welcoming and more accessible if we are going to be the church that God is calling us to be in the future. Now and in the future, we are called to expand God’s love through connection and outreach.

Our greatest glory lies ahead of us. You can catch a glimpse of that in the following pages, and we will be sharing that vision as a church in the months ahead.

I invite you to be part of it!

In Christ,

Richard



A History of Community A Need for Growth

Since 1799, before Dayton *was* Dayton, our church has been here, loving God, loving neighbor, and changing lives. In 1926, as Westminster Presbyterian Church, we moved into a new building, a magnificent Gothic cathedral designed by the renowned American church architect, Ralph Adams Cram. Today, at a time when other churches are closing their doors, our congregation is thriving—new members are joining, our children's and youth choirs are growing, our classrooms are full—we continue to serve the greater Dayton community by sharing God's human connection and care.

**Our building is beautiful
and historic, but it is
holding us back.**



We Have a Vision for Mission

We could do **MORE** of what we do for Dayton
and we could do it **BETTER**

We serve the Dayton community in many ways, by hosting:

- Oakwood High School Baccalaureate Service
- Montgomery County Prosecutor's Office Victims of Homicide Service
- DECA Middle School graduation ceremony, teacher training days, school-wide assemblies
- Dayton Gay Men's Chorus Christmas Concert
- Meetings of the Recovery IS Empowering (RISE) Court Program
- Bach Society of Dayton
- Miami Valley Pipes and Drums
- Our ID Ministry
- MADD Camp
- And others

If we make the building more accessible and welcoming, we could do MORE of what we are called to do for Dayton - connecting and caring as we love God and neighbor - and we could do it BETTER.



Stairs

are

Everywhere

Wheelchair access is available only at the back door.

The existing elevator is cramped for wheelchairs, walkers, and strollers.

Access to Fellowship Hall is difficult and circuitous.

None of the restrooms are ADA compliant.

The Nursery and rooms on the east side downstairs are inaccessible to people who can't use stairs.

Accessibility would allow us to welcome everyone, from the street to the pew or Fellowship Hall: short, easy, safe, and no steps.

- New drop-off on Wilkinson Street: 3 cars in the queue, an inset space to get out of the lane of traffic.
- Covered canopy, and automatic door opener.
- Inside the expanded entrance: Ramp or short stairs to cloakrooms and large ADA restrooms.
- New large elevator up to the Narthex, the preferred entrance to the church for worship.

No More

Barriers

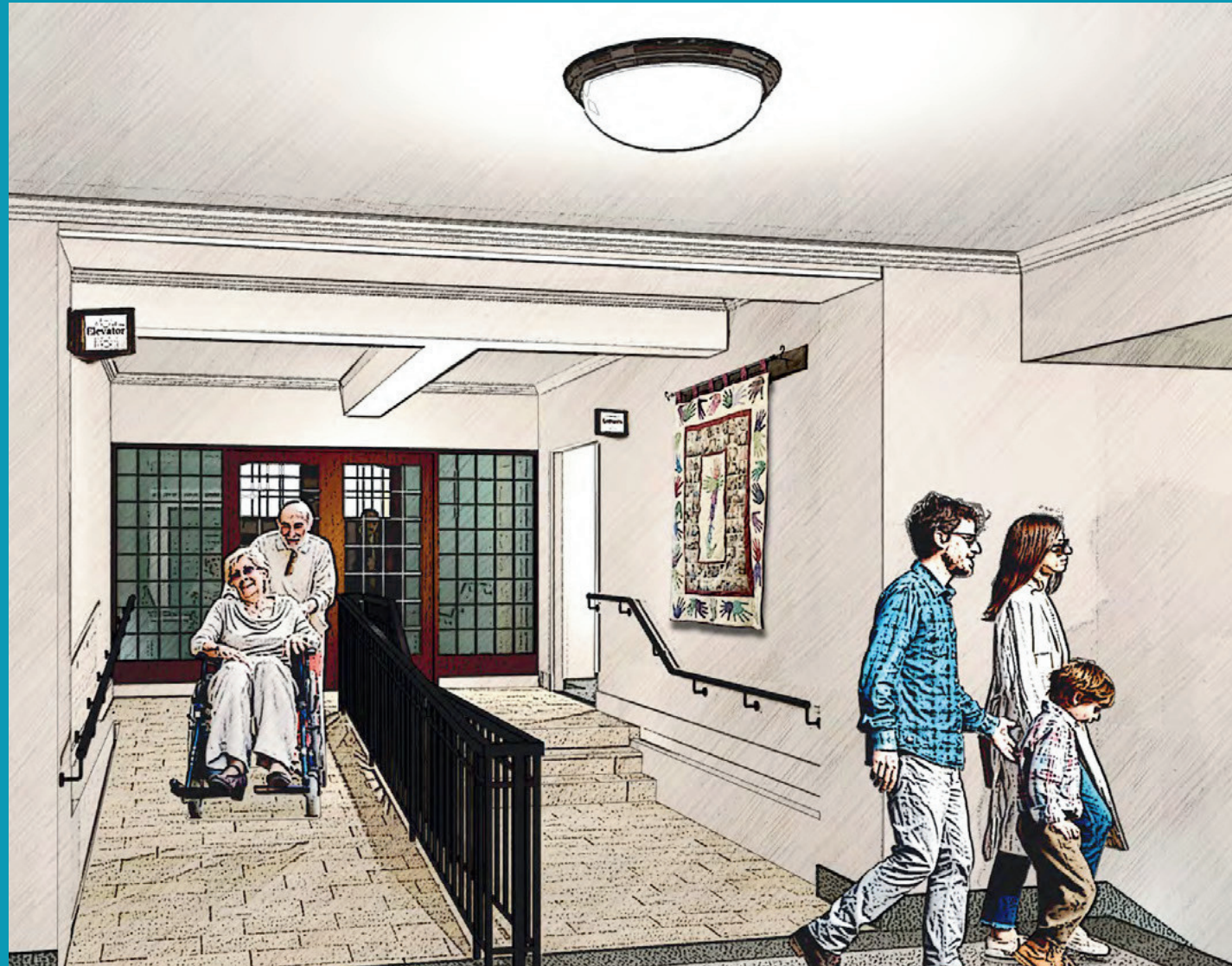

“Merrily we roll along, wheelchair along, walker along... We’ll be able to sing the finish of this verse, very merrily, as we roll along and walk along our new Westminster Entrance.” -Betsy Whitney

Grand Spaces to Connect



Along with the Sanctuary, Fellowship Hall is the heart of our welcoming activities at Westminster. It is a center of community and caring. Renovations will make it even more welcoming.

- New Grand Ramp opens up Fellowship Hall from Heritage Hall.
- Access to the ramp from the top of the horseshoe in Heritage Hall or from either the east or west hallway at midpoint.
- Nursery and rooms on both sides of Fellowship Hall accessible without steps.
- Current men's restrooms on the Sanctuary and lower level converted to two ADA compliant family restrooms.
- New large ADA compliant restrooms on this level.

FLEXIBILITY For Whatever Comes Next



**Learning and service are at the heart of Presbyterianism.
These improvements will help us do more of both.**

- Leveling the floor and opening up the Chapel Reception Room allows for more efficient use of the space for our robust ID Ministry.
- The Chapel can be used as a larger classroom with moveable furniture, for our growing Parents' Fellowship Class, Youth Program, and others.
- The raised worship space at the east end will remain, so the Chapel can be used as a traditional chapel when desired.

Little Changes, **Big Impact**



Photo Credit: Brian Swartz

New up-lighting will brighten the space and draw attention to Westminster's gorgeous buttresses and painted ceiling panels, inspirations in themselves and heavenly reminders of the love and creativity built into this house of worship.

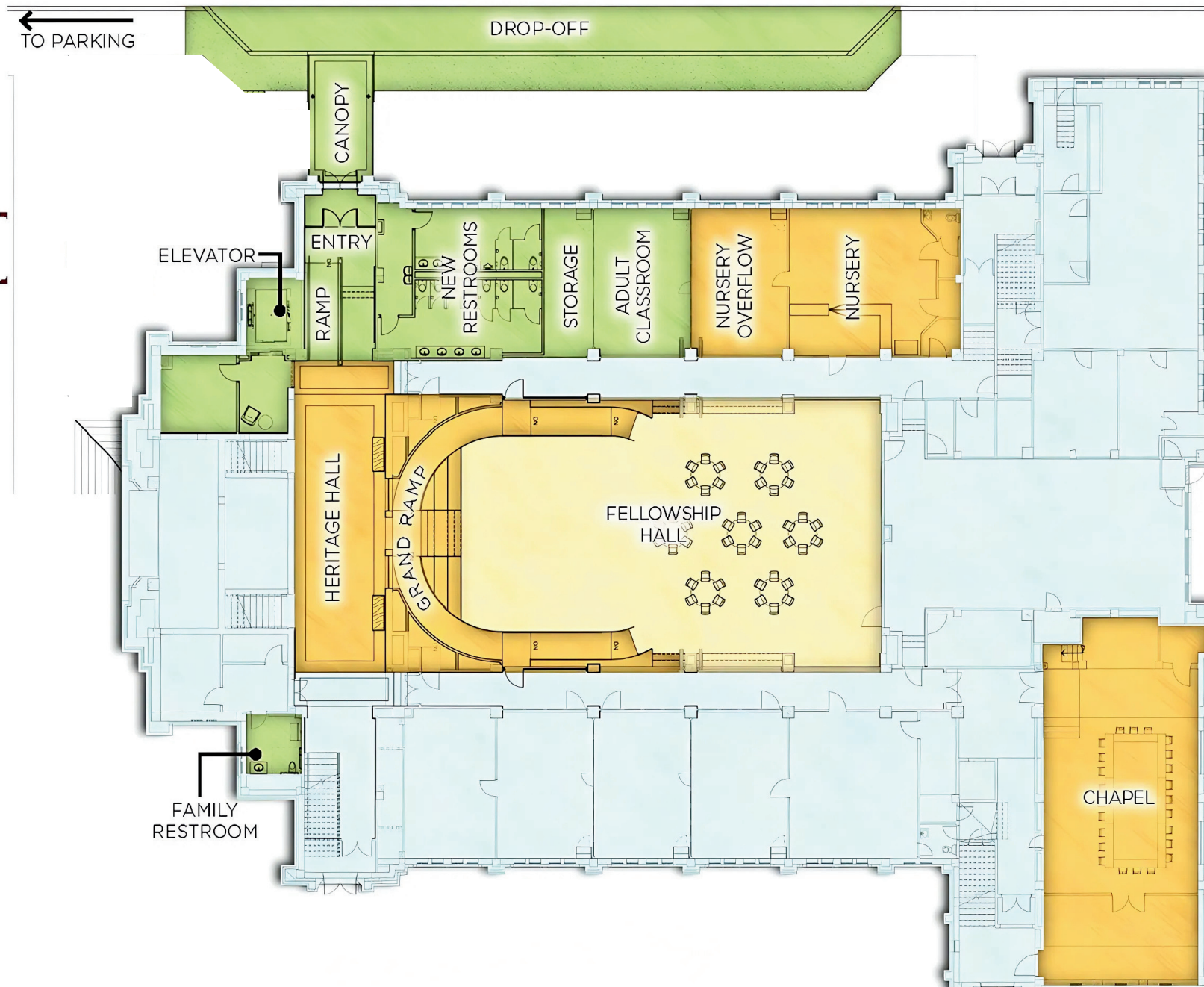

Phase 1 Hospitality

Renovation of Fellowship Hall and the Nursery. New lighting in the Sanctuary. A versatile mission space in the Chapel.

Phase 2 Accessibility

New drop-off and accessible entry on Wilkinson St. Installation of new large elevator. New ADA compliant restrooms.

“Betsy Whitney and I, as honorary chairs, are particularly pleased with the planned improvements of accessibility for all people in the congregation, as well as continuing to welcome members and visitors for generations to come.”

- Judy McCormick

Let's Connect

The Rev. Dr. Richard Baker

richard@westminsterdayton.org
(317) 409-3554

Donna Schoonmaker

donna@westminsterdayton.org
(937) 223-7285

Betsy Whitney - Honorary Chair

Dave Boezi - Campaign Chair

rdboezi@gmail.com
(937) 710-3993

Rachael Boezi - Campaign Chair

rboezi@hotmail.com
(937) 308-0181

Judy McCormick - Honorary Chair



Westminster Presbyterian Church

www.westminsterdayton.org
(937) 223-7285